

250 & 300 VRTT

INDEX

	Page
1. INTRODUCTION	2
2. INSTALLATION	
2.1 Fitting the Thruster	
2.1.1 Placement	3
2.1.2 Lifting	4
2.1.3 Hull fitting	4
2.1.4 Raise/Lower setting	6
2.1.5 Painting	7
2.2 Thruster Main Drive Installation	
2.2.1 Hydraulic	8
2.2.2 Electric	9
2.3 Thruster Electrical Control Installation	14
3. OPERATION	22
4. MAINTENANCE	
4.1 Periodic Maintenance	24
4.2 Cathodic Protection	25
4.3 Manual Operation	26
5. DRAWINGS	27
WARRANTY	

1. INTRODUCTION

The Lewmar VRTT Thruster has been designed to give excellent service and a long life providing that it is installed and serviced properly.

This manual provides the information required for the correct installation of your new Lewmar VRTT Thruster

This manual applies to the following thruster models:

- 59127002 – 250 VRTTH (low displacement)
- 59127004 – 250 VRTTH (high displacement)
- 59127100 – 250 VRTTE 24VDC
- 59127110 – 250 VRTTE 48VDC
- 59137001 – 300 VRTTH (low displacement, aluminium)
- 59137002 – 300 VRTTH (low displacement, bronze)
- 59137003 – 300 VRTTH (high displacement, aluminium)
- 59137004 – 300 VRTTH (high displacement, bronze)

If there is any problem found during installation or use, contact your nearest Lewmar agent or contact us at www.lewmar.com

Note. Additional accessories such as control panels and looms may be required for the control of your new thruster.
Please refer to section 2.3 (page 14.)

IMPORTANT:

- **Please ensure that you thoroughly understand the operation and safety requirements of the thruster**
- **Your thruster should not be operated close to swimmers as a powerful suction of water is generated when in use.**
- **All hull modifications should be carried out by a specialist.**
- **We recommend that a qualified person install the thruster. Faulty installation could place the boat and crew in danger and make the warranty invalid.**
- **Do not use the thruster assembly as an earth point**

2. INSTALLATION

These are guidelines only it is recommended that a professional marine engineer perform the Thruster installation.

2.1 Fitting the Thruster

The VRTT Thruster is supplied with the leg raised for ease of installation. Correct installation of the Thruster, associated equipment and the watertight integrity of the vessel is the responsibility of the installer.

2.1.1 Placement

The Thruster should be installed as far forward as possible. When the VRTT is lowered to the Thrust position, the centre line of the hub must be a minimum of 1.5 x propeller diameter below the water line and clear of the hull. The performance of the Thruster is largely due to the power source supplying the Thruster motor.

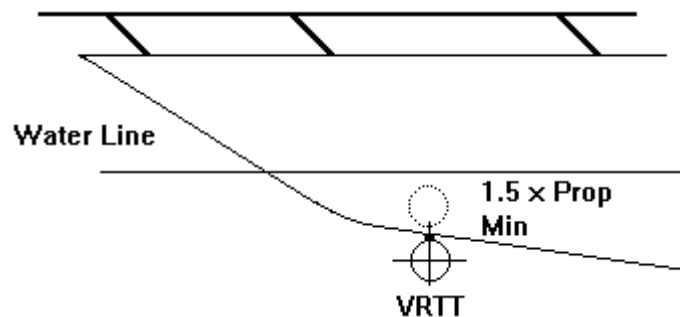

Adequate space should be allowed inside the hull for hydraulic hoses, electric cables and access for service etc. It is also important that the area around the thruster be kept clear of any loose items. It is recommended that if the area is to be used for additional storage that a removable cover or barrier be constructed around the unit to prevent damage to the unit. This area must also be kept dry to avoid damage to the electric motors and that they have sufficient room to breath, ideally housed in a ventilated area. If a 250VRTTE is fitted the electric thrust motors will get hot.

It is important that nothing can cause jamming of the raise/lower mechanism or damage to the stop switches.

2.1.2 Lifting the unit

The Thruster is heavy so when lifting the Thruster unit from its packing case, ensure that adequate lifting strops are used. The Thruster should not be lifted by its lead screw assembly or propeller shroud. Extra caution should be used to avoid damaging these parts, the micro switches and control box. When moving the Thruster, ensure that the seating surfaces of the main housing are protected against potential damage. The control box is secured to the Thruster for protection during transit. A picture is included in the transport box showing advised lifting method.

2.1.3 Fitting into the hull

The thruster requires a watertight compartment to be constructed within the hull to house the shroud assembly, with an opening in the bottom of the hull for the shroud to be lowered through.

The top of this watertight compartment is to act as the mounting seat for the thruster base plate. This watertight compartment must be designed to take the weight of the thruster, the transfer of thrust to the hull and any additional forces created while the vessel is in motion. It is recommended that this is carried out by a qualified navel architect.

When planning the Hull piece cut-out and watertight box, it is important that the box gives adequate all-round clearance for the shroud of approx 5-10mm (3/16-3/8"). Once the Thruster seating support has been fabricated and a suitable hole has been cut in the hull, the Thruster can be installed.

Seat the unit down on a thin gasket of closed cell neoprene or a suitable sealing compound. The base plate is pre-drilled with 8.5mm holes (250 VRTT) or 10.5 holes (300 VRTT) see unit diagrams. It is recommended that stainless steel bolts of property class 70 are used with nuts, plain washers and locking washers. If fitting into an aluminium hull the base plate may be welded to the watertight box. The thruster base plate is corrosion resistant 5083-T6.

The VRTT Thruster is supplied in the retracted position for ease of transportation. The Thruster will need to be lowered once located, to have the hull faring fitted. To lower the Thruster, either energise the raise/lower motor or by using the mechanical lead screw (refer to Manual Raise/Lower section for details).

Usually, the hull piece that has been cut out of the hull would be re-used to provide the Thruster closing plate. This can be attached to the ribs moulded into the tunnel shroud. The raise lower motor can take a hull piece up to 50kg (110lbs). If additional bolts are being used, ensure that the bolt heads do not foul the propeller tips inside the shroud. A landing or register (see diagram below) should be moulded into the hull cut out, to allow the hull closing piece to 'locate' when the Thruster is fully retracted. This is to prevent water flooding

the box at high pressure potentially damaging the gasket/seal and to eliminate load being applied to the Thruster leg when the vessel is pounding at sea.

A sealing gasket is recommended between the closing plate and hull register. This should be of a resilient material that will not cause sticking of the closing plate and undue load on the raise/lower mechanism.

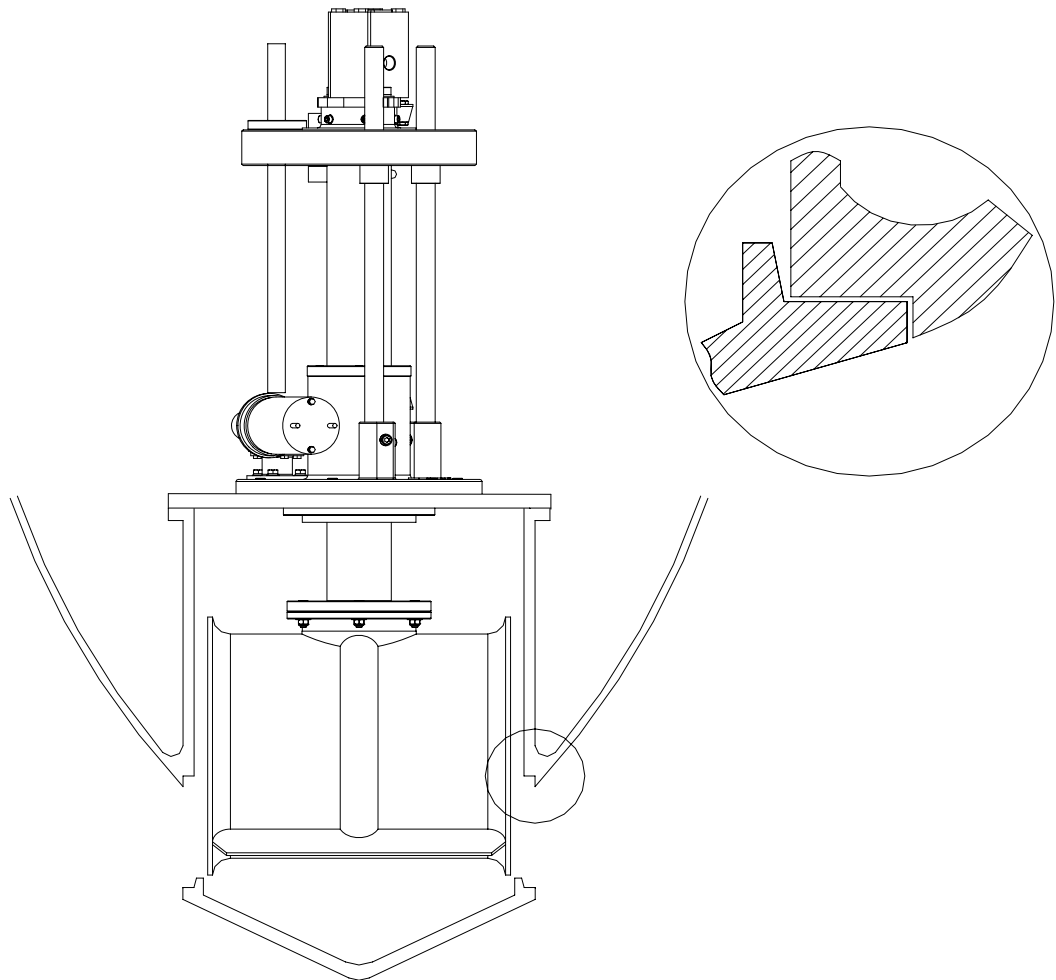

2.1.4 Raise/Lower Setting

The limit switches are factory set at a pre-determined safe setting and will require adjustment during installation. The Limits switches are activated by the adjustable stops.

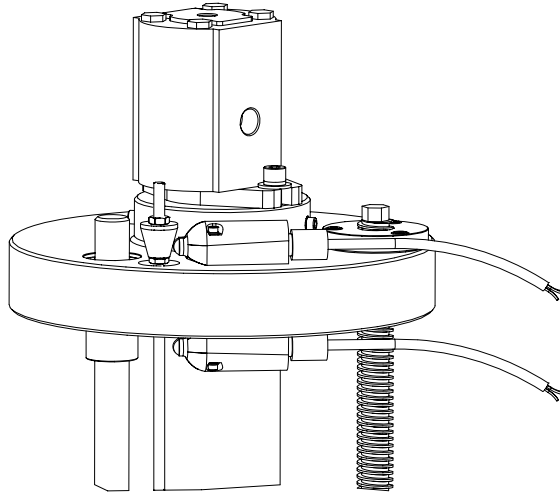

The stops can be adjusted by loosening the lock nuts either side of the stop with a 13mm spanner, adjusting and re-tightening sufficient to stay in position but not crush the plastic stop. It is suggested that to guarantee trouble free operation that a thread locking compound (i.e. Loctite 243) is applied to the nuts on final setting.

When raised ensure that the limit switch actually 'makes' when the Thruster is fully retracted or deployed, otherwise power will be left on the Raise/Lower motor applying unnecessary stress to the shroud / closing plate assembly.

When in the lowered position make sure that the top plate does not make contact with the top face of the lower housing. Failure to do this will cause undue loading and prevent the raising of the thruster.

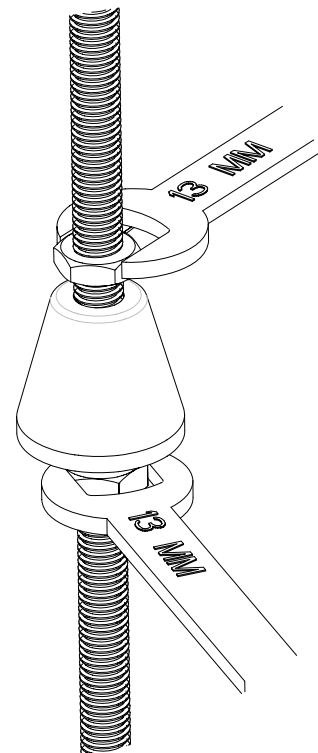

2.1.5 Painting/protection

The Thruster base plate is supplied bare aluminium ready for anti-fouling. There are 6 anodes fitted to the under water area, 2 on the propeller shafts and 4 mounted directly on to the base plate, these must **not** be painted or anti-fouled as this will prevent them from protecting the unit. The underside of the installation plate **must** be treated with an appropriate primer and antifoul/paint as this is part of the corrosion protection system. Hub (bronze or aluminium check version) and propeller may be anti-fouled. Always use the appropriate anti-fouling that is compatible with surface being covered, refer to antifoul/paint manufacturers instructions ensuring a through coverage of all exposed surfaces. The shroud comes pre-gel coated and generally does not need any additional coatings, however this is at the installer's discretion.

Under no circumstance should any paints or anti-fouls be applied to the stainless steel main leg.

NOTE:-

The installation of bars or grids across the tunnel entrance will have an effect on the thruster performance.

They would need to be checked regularly and be removable for maintenance.

Any foreign body that passes through the bars may cause additional damage, as it won't have an easy escape.

2.2 Thruster Main Drive Installation

2.2.1 VRTT Hydraulic

Flow and Pressure requirements

250VRTT - 15kw output	300VRTT - 22.5kw output
(16.8cc Rev Motor) Flow = 53 l/min Pressure = 190 bar (ΔP)	(26cc Rev Motor) Flow = 72 l/min Pressure = 210 bar (ΔP)
(26cc Rev Motor) Flow = 82 l/min Pressure = 122 bar (ΔP)	(30cc Rev Motor) Flow = 82 l/min Pressure = 182 bar (ΔP)

The hydraulic motors are supplied pre-tested with female ports and blanking caps.

Ensure the correct pipe bore sizes/pressure ratings are installed as per hydraulic requirements, refer to a competent hydraulic installer if in doubt.

Hydraulic motor ports 250 & 300 VRTT

A + B = 3/4" BSP

Drain = 1/4" BSP

NOTE: Motor Drain line must be connected

Equipment should be accessible to allow for routine maintenance, oil changes etc. Keep tight bends and hose couplings to a minimum wherever possible. Where hoses pass through bulkheads or near sharp edges, ensure pipe clamps or additional shielding of the hose is undertaken to reduce the risk of chaffing.

Hydraulic units must be checked for stray current along the supply hoses. If found the motor must be fitted with correctly rated and sized insulated hoses. Lewmar cannot accept responsibility for corrosion caused by stray voltage.

When first operating the Thruster, pulse the controller to charge (fill) the hydraulic motor.

2.2.2 VRTT Electric

59127100 – VRTTE 24Vdc. This thruster is 24Vdc only and requires a main high current supply to the main drive thruster motor and a separate 24Vdc supply to the Raise/Lower control system.

59127110 – VRTTE 48Vdc. This thruster is 48V/24Vdc and requires a high current 48Vdc supply to the main drive thruster motor, but a separate 24Vdc supply to the Raise/Lower control system.

N.B. A Lewmar TT P/S Battery Switch box is supplied with this thruster to enable the installer to double a 24Vdc supply to 48Vdc to the thruster using additional batteries. – **Please refer to the P/S Battery Switch installation manual**

A suitable Battery Isolator switch that can handle the thruster current and a correctly sized fuse and fuse holder should be installed in the positive line. The location should be easily accessible and known to the responsible person on board.

The thruster battery switch must be switched off when no one is on board. It is also advisable to switch it off when the thruster is not in use.

Install the battery/s as close as possible to the thruster, thus keeping the main supply cables as short as possible, which will in turn keep the voltage drop to the minimum.

Battery cold crank capacity should be at least equal to the thruster current.

The cables should be terminated with a ring terminal corresponding to the motor studs – 10mm (3/8") It is important that this termination is secure so that the high current is transferred to the efficiently.

The minimum voltage at the motor when running should be 21V

Ensure insulating boots supplied with the unit are correctly fitted.

Note. If very large cables are used, discard supplied boots and fit appropriate sized ones.

24Vdc:

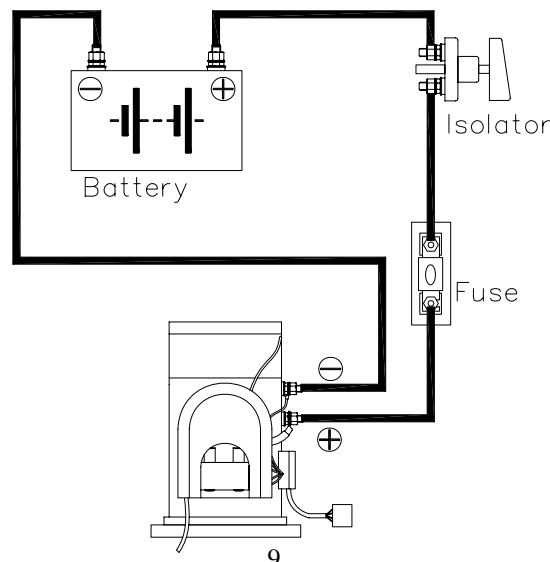

48Vdc:

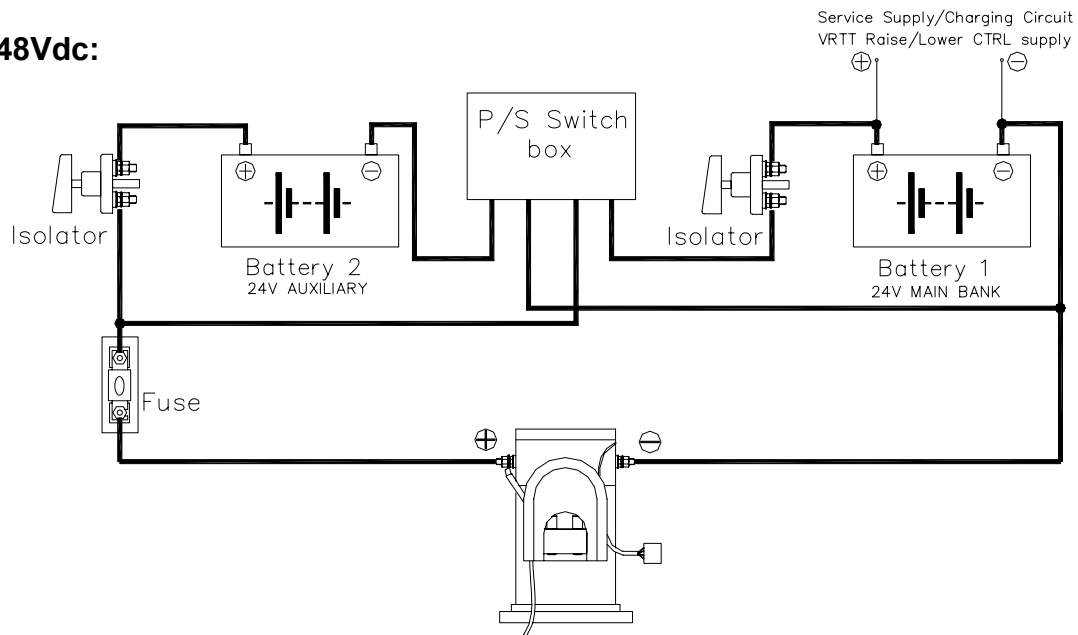

Refer to chart below for recommended Cable size based on maximum voltage drop, depending on run and fuse required.
Lewmar also supply a fuse holder 589013.

Maximum total cable run Battery to Thruster and back						
Cable CSA mm						
	35	50	70	95	120	150
24V	9M	12M	21M	28M	36M	45M
48V	21M	31M	42M	58M	75M	-

Fuse	Part No.	Current
400A	589010	520A
250A	589008	340A

Cable AWG						
	2	1	0	00	000	0000
24V	29ft	41ft	52ft	66ft	84ft	105ft
48V	68ft	86ft	108ft	138ft	174ft	218ft

Electric bow thrusters use powerful electric motors, it is very important that there is sufficient battery capacity and large enough cables for safe operation. Using smaller than recommended batteries and cables will cause loss of performance and may cause dangerous overheating.

Electric motors spark and run hot. Do not place near flammable or sealed areas

The main battery must not be connected and power must not be switched on until all covers and terminal protectors are correctly fitted.

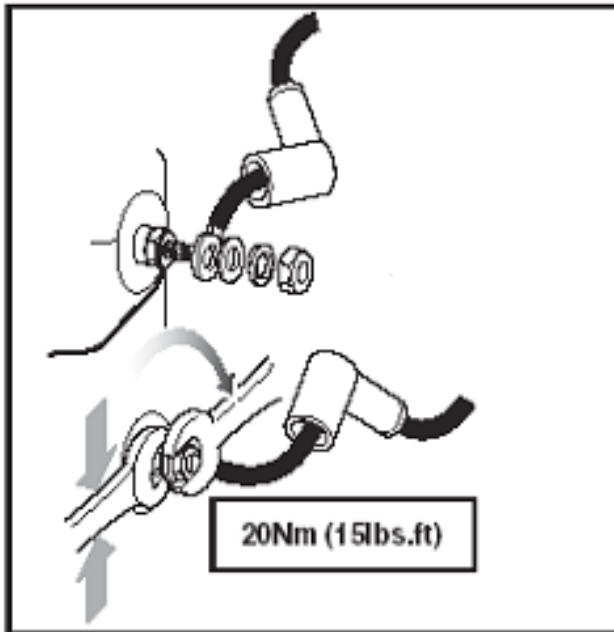

When fitting the power cables to the thruster make sure that the cables are of sufficient length and supported to allow for the vertical movement of the thruster

Incorrect installation of battery cables or damage to connection studs may result in a short to the thruster body. Use the examples on the next page to check for a correct installation on both +V and 0V battery connections.

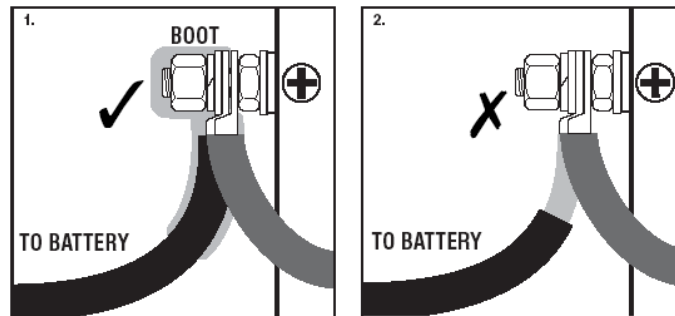

1. Correct installation. Supplied cable boots are used and no bare wires exposed.
2. Live wire exposed! Correct the cable installation to match illustration 1

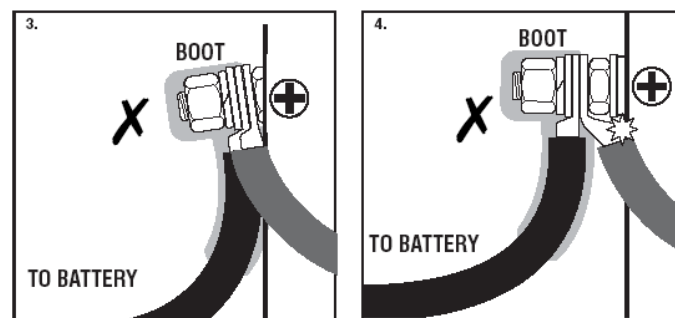

3. Terminal or motor is damaged. Contact Lewmar Ltd
4. Crimp inverted and is touching motor! Correct the cable installation to match illustration 1

To prevent electrolytic corrosion or faults, the thruster motor body and assembly must remain isolated from any power supply or grounds.

The installer can check for this using a multimeter in the following ways:

Test 1

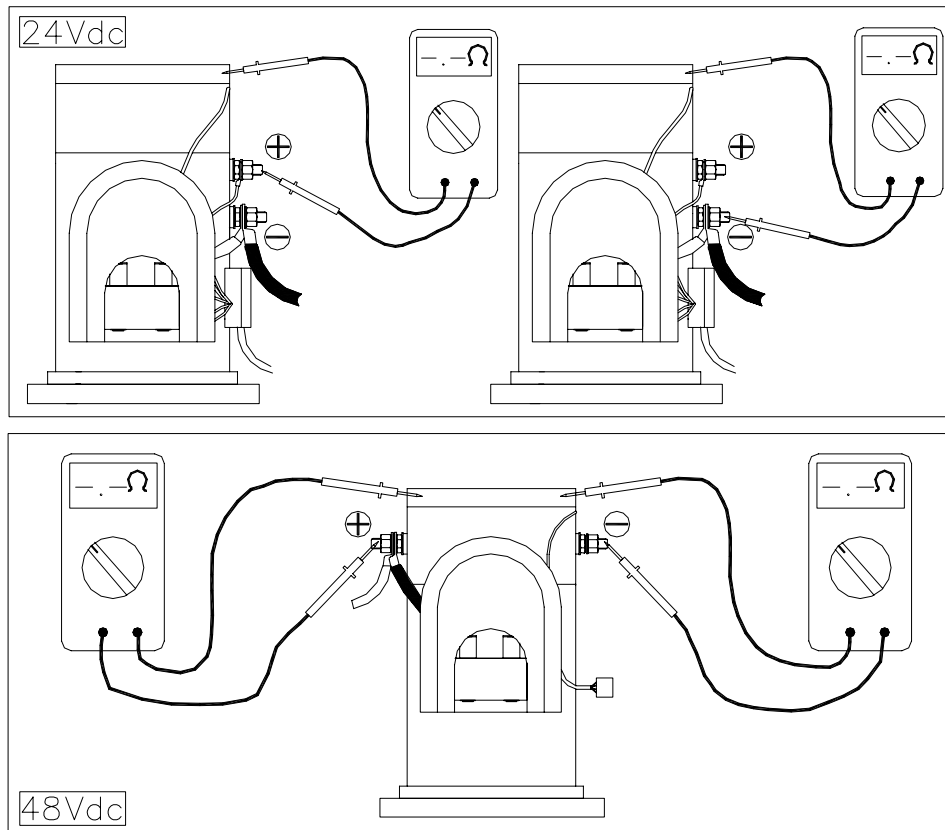

With the negative not connected and the positive cable connected but with the battery switch off or fuse removed. Use a continuity tester to check for a connection between -ve stud and motor body and also between +ve stud and motor body. In both cases the meter should give no indication of electrical connection.

If a connection is measured between the +ve stud and the motor body, check installation for cables or wires touching the assembly.

If a connection is measured between the -ve stud and the motor body, remove any bonding straps to the assembly and check as before.

Test 2

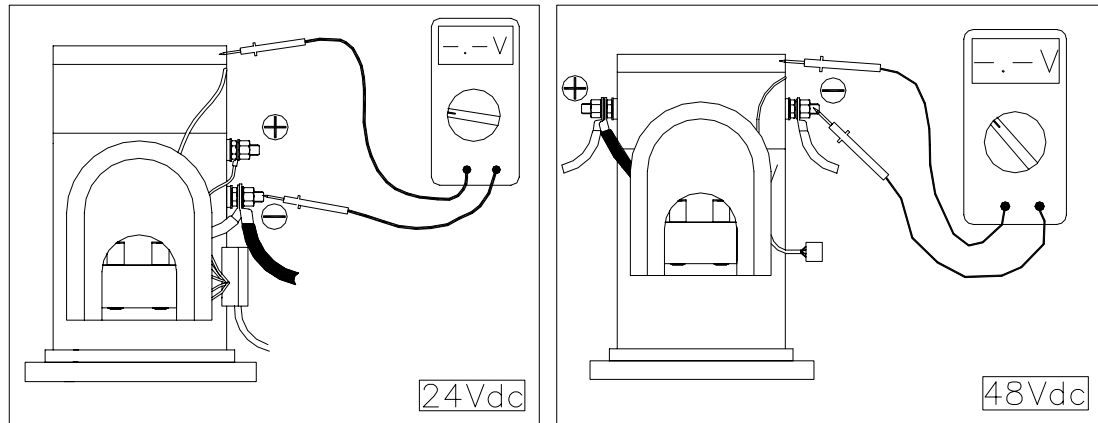

With the battery applied: Use a voltmeter to test the voltage between the –ve stud and the thruster motor body. If the supply voltage is measured, disconnect power immediately and inspect the assembly for faulty installation or damage.

IMPORTANT:

- **Do not run the thruster out of the water, even for a few seconds, the motor will overspeed by 300% causing damage to the seals etc. and invalidate the warranty**
- **Any foreign object in contact with an operating propeller will cause serious injury or damage and invalidate the warranty.**
- **Thrusters must not be installed in 'wet' areas or areas where splashing is likely, damage to the electric motor may occur.**

2.3 Thruster Electrical Control Installation

The 250/300 VRTT thruster is supplied with a Raise/Lower control box pre-wired to the thruster limit switches, raise/lower motor and main drive motor control (VRTTE only). The operation and factory fitting of the control box and raise/lower assembly is tested prior to shipment.

A flying lead is supplied for connection of the power supply to the control box
Input power supply required: 24VDC 5A nominal.

This must be from a separate source to that used by the main drive motor if installing a VRTTE. Note also that the supply must be suitable to handle a dc motor inrush current of 45A for 10mS.

The control box is fitted with a circuit breaker, which is sized specifically such that it will trip if an obstruction is encountered in the raise/lower mechanism during operation.

This control box is supplied with a mounting bracket for ease of installation. The cables that are pre-fitted to the box have an excess of length to aid the installer in finding a suitable location.

Be aware when mounting this box that the cables fitted to the limit switch and drive motor (VRTTE) will require enough play to allow for the raising and lowering of the thruster assembly during normal operation.

VRTTH only:

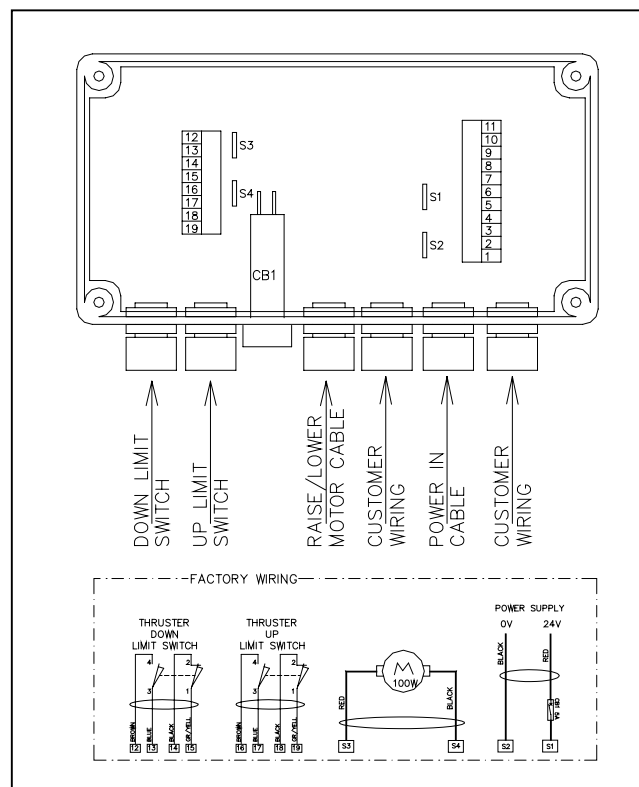

VRTTE only:

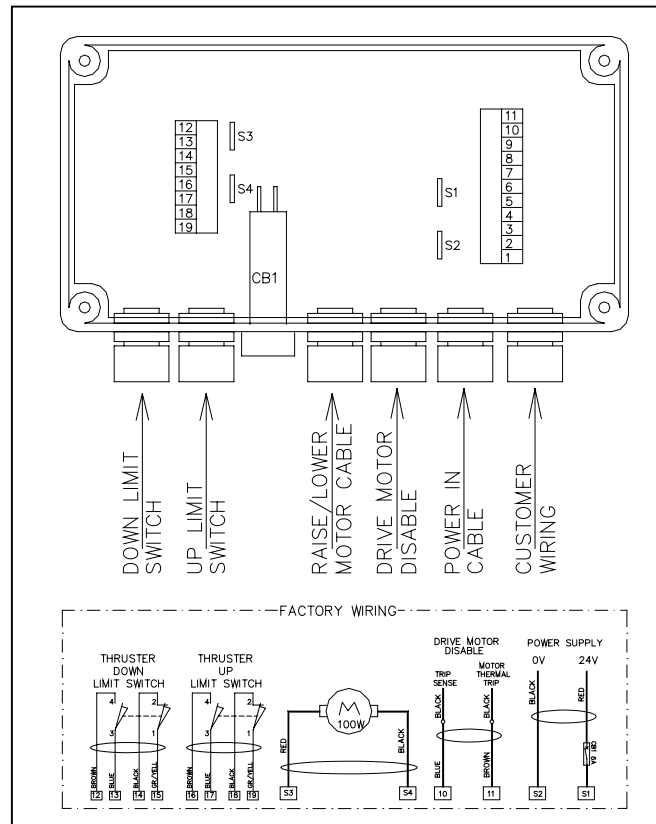

The control connections available for customer installation are as follows

- 1 – Power supply to raise/lower control switches & lamps.
- 2 – Switched (latched) power in to box to enable raise/lower control.
- 3 – Switched (momentary) power signal in to initiate a thruster raise operation.
- 4 – Switched (momentary) power signal in to initiate a thruster lower operation.
- 5 – OV supply to raise/lower control switches & lamps.
- 6 & 7 – Volt-free contact (5Amax) Closed circuit when the thruster is in the UP position.
- 8 & 9 – Volt-free contact (5Amax) Closed circuit when the thruster is in the DOWN position.
- 10 & 11 - Volt-free contact (5Amax) Closed circuit when the thruster is in the DOWN position. Not available on VRTTE

Note these connections are made to a two part terminal block that can be removed from the PCB to aid connection of wiring.

This control box is for the operation of the thruster raise/lower mechanism only and does not control the hydraulic/electric main thruster drive.

A user interface control panel for controlling the raise/lower mechanism and main thruster drive has been designed by Lewmar Ltd specifically for this thruster and may be ordered separately, part number 58400612:

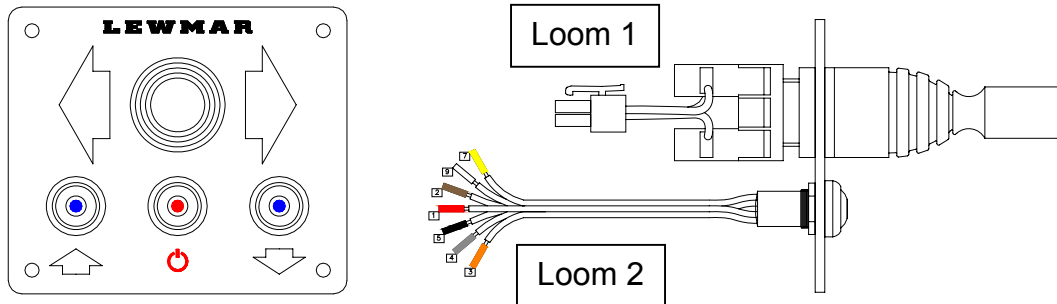

The panel dimensions are 100mm X 85mm. And is rated IP67 above the panel when installed correctly with the use of a suitable gasket or sealing compound.

The panel is supplied pre-wired with two colour coded looms: Loom 1 for direct interface with the VRTT control box and Loom 2 for either direct interface to the VRTTE main drive motor control (black box) or for hydraulic valve control.

The colour coding is as follows:

Loom 1:

Wire	Description	Connector Pin
White	Joystick Switch Common	4
Grey	Thrust to PORT Signal	3
Blue	Thrust to STBD Signal	2

Loom 2:

Wire	Description	Control Box Connections
Yellow	Raise Switch Position Indicator	7
White	Lower Switch Position Indicator	9
Brown	On/Off switch / Control Enable	2 & 6
Red	+V Panel Supply	1 & 8
Black	0V Indicator Common	5
Grey	Lower Switch Signal	4
Orange	Raise Switch Signal	3

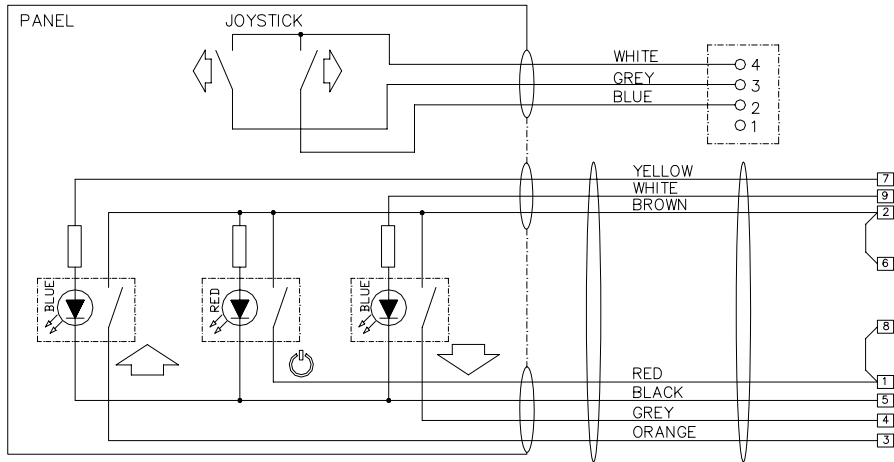

Loom 1 of the VRTT control panel is interfaced with the VRTTE main electric drive motor 'Black Box' control unit using standard Lewmar TT thruster control loom connecting cables sourced separately:

Cable Length	Part Number
2M	589021
7M	589016
10M	589017
14M	589018
18M	589019
22M	589020

The 7-way control loom (2) for the raise/lower control of the thruster must be sourced by the installer. This loom must have a minimum current carrying capacity of 1 Amp and should meet all relevant standards and regulations.

Note the VRTTE has additional wiring fitted to the thruster assembly and VRTT control box that is used to disable the main drive control for when the thruster is not in the lowered position.

VRTTE Main Drive Control & Power Connections

24Vdc:

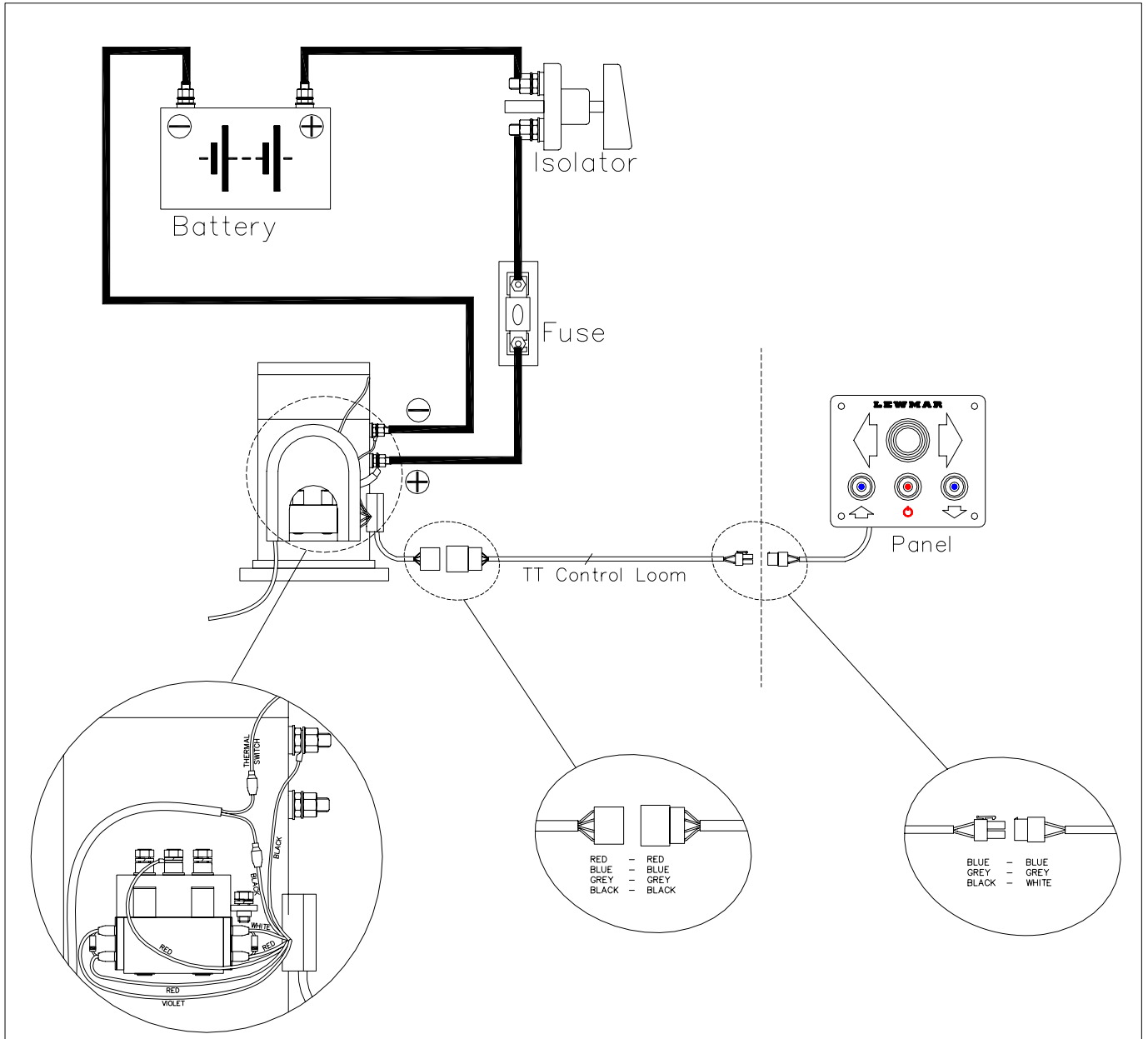

VRTTH Main thruster drive control:

The switched joystick on the VRTT panel can also be used for valve control on a VRTTH installation.

Note, the connector supplied on loom 1 will have to be discarded.

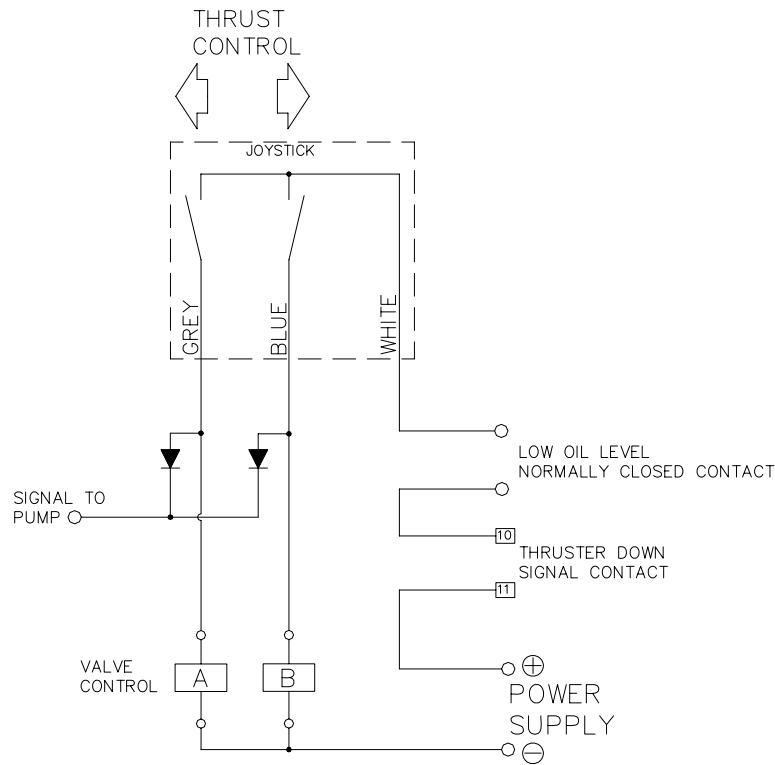

This is a basic wiring diagram to aid the installer in the basic control of the hydraulic thruster.

These controls must be powered from a separate fused circuit.

As a matter of safety and for the prevention of damage to the thruster, it is necessary that the second thruster-down volt-free contact in the VRTT control box is wired into this circuit to prevent the operation of the main drive motor when the thruster is not in the lowered position.

The volt-free contacts and joystick contacts are suitable to switch 5A. It is also recommended that a hydraulic oil reservoir level switch is included in the circuit to prevent operation of the thruster if there is insufficient oil.

In most cases the VRTTH is integrated into a hydraulic system where there are existing hydraulic controls. If this thruster is part of a complete Lewmar hydraulic/electric system, please refer to the main system manual for piping and wiring information.

For VRTT installations where the VRTT panel is not used, the following wiring

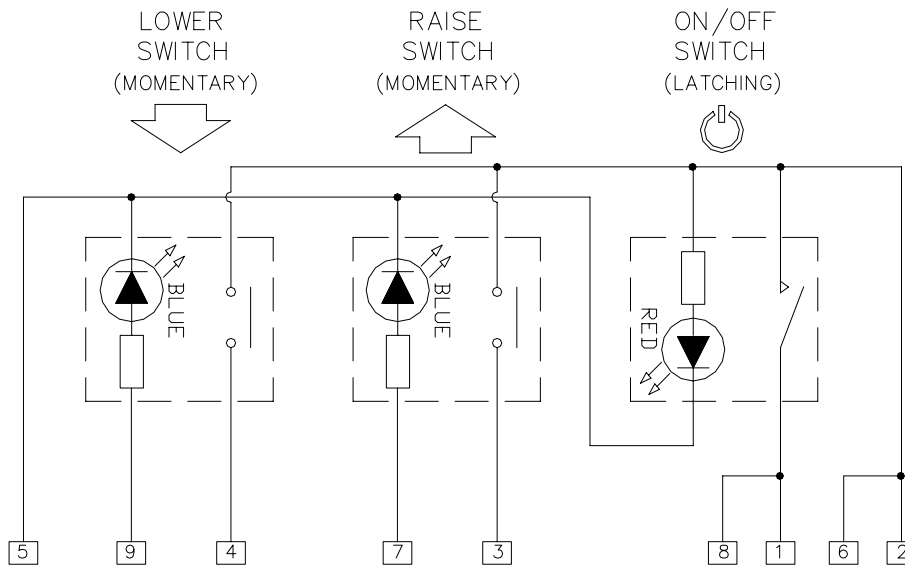
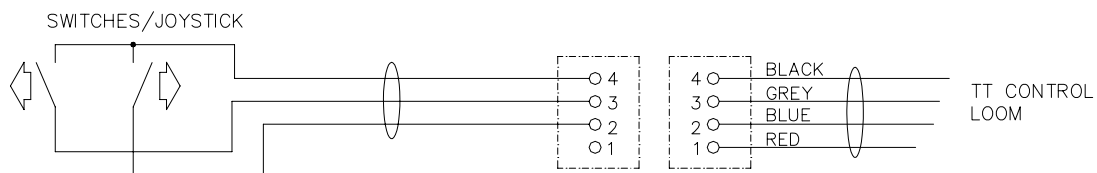

diagram indicates the correct control wiring to the VRTT control box. The raise and lower switches must be momentary action and the on/off switch a latching action. The circuit shows LED indicators but filament bulbs can be used.

For VRTTH main drive installations without the VRTT panel use the circuit on the previous page as a guide.

For VRTTE main drive installations without the VRTT panel either basic momentary switches or a switched joystick may be used to interface with the motor controls, see below, alternatively a TT control panel may be used for main drive control only, refer to the TT thruster manual.



3. OPERATION

This section details the operation of the thruster based on the installation of the VRTT panel, if this panel was not used the operation may differ.

The panel consists of three pushbuttons with integral indicators: Thruster-Raise(momentary), Thruster-Lower(momentary) and System On/Off(latching) Also there will be either a switched joystick or pushbuttons for control of actual thrusting.

The operation of these controls is as follows.

System On/Off switch.

When pressed this will enable the operation of the VRTT system, enabling the control box and supplying power to the raise/lower switches. The switch lamp will illuminate (Red) to indicate this, at the same time the raise/lower switches will illuminate to indicate the position of the thruster – raised or lowered.

De-selection of this switch will disable the VRTT control box and hence halt any operation even if the thruster is in mid stroke of raising or lowering.

Raise switch.

Enabled when the On/Off switch is On, a brief push of this switch will cause the thruster to automatically retract if not already fully retracted. The integral switch lamp will illuminate (blue) when the thruster is fully retracted.

Lower switch.

Enabled when the On/Off switch is ON, a brief push of this switch will cause the thruster to automatically deploy if not already fully down. The integral switch lamp will illuminate (blue) when the thruster is fully lowered. Note the lamp will indicate if the thruster is down whether the On/Off switch is selected or not – **the thruster should always be raised when not in use.**

Only once the thruster is fully lowered will the thrust control joystick or switches be enabled.

If the system on/off lamp is illuminated but neither of the raise or lower switch lamps are lit then the thruster has been halted in mid stroke due to either the system being switched off to early previously or due to an obstruction. It is advisable to check the unit for obstructions before moving the thruster again.

The VRTT control Box features a Circuit breaker that is sized such that any obstructions to the movement of the thruster to retract or deploy will cause the circuit breaker to trip which will remove power from the VRTT control system. The circuit breaker can be reset by pushing the trip button back in, But what ever caused the obstruction must be removed before attempting to switch the system on again.

Note:

- i) As a safety feature if the thruster is in the lowered position and the panel is switched off the down light will stay on, it is dangerous to get underway with the Thruster not in the fully raised position.
- ii) If power is switched off during the Raise /Lower operation, all lights will go out and the thruster will stop mid-stroke. Switch the system on and press the UP button so that you are certain that the Thruster is parked.

WARNING

- The Thruster must not be operated whilst the vessel is out of the water as damage may occur.
- The VRTT has a large surface area and so in the down position the vessels forward or reverse speed should be kept to a minimum. Failure to do so could damage the unit.
- Contact with an underwater object will cause damage to the GRP shroud and possible failure of the Thruster.

4. MAINTENANCE

4.1 Periodic Maintenance

In general very little maintenance of the Thruster is required.

General

- The Thruster should be Lowered and Raised on a regular basis to prevent seizing of the unit leg.

6 Months

- Remove any build up of oil/grease and dirt from the mechanism.
- Wipe clean Raise/Lower Lead Screw, apply a light coat of oil and grease guide bars.
- Check condition of Anodes, if decay is more than 50% then replace (it is advised that all anodes are changed together)

12 Months (to include previous checks)

- Grease Main Bearing Grease Nipple
- Check tightness of Motor Terminals (250VRTTE only)
- Check tightness of Nuts and Bolts, re-tighten to correct torque
And apply locking compound if required (see assembly diagram)
- Check condition of propellers, replace if damaged
- Clean debris from Leg, Shroud.
- Check Shroud for cracks or damage, replace if necessary
- Clean Carbon dust from motor brush gear using a soft brush
And vacuum (250 VRTTE only)

24 - 36 Months (to include previous checks)

- Check Raise/Lower Lead Screw and Manual over-ride bolt for excessive wear, replace if necessary.
- Check condition of Electric Motor Brushes (raise/lower motor all thrusters, 250VRTTE main motor) replace if necessary.

Vessel Storage out of the water

- Hose down external components (Hub, Leg etc) with fresh water and Grease leg. Fully retract the hub unit to prevent damage.

Note

The Thruster hub is a sealed unit and does not require general maintenance, if a problem is found, please contact your nearest Lewmar representative.

Hydraulic system maintenance should be carried out in accordance with the manufacturers instructions. Failure to do this will result in the reduced life of the VRTT hydraulic main drive motor.

4.2 Cathodic Protection System

When the boat is first commissioned it is important that the Anodes are checked frequently at one-month intervals. Check for signs of excessive corrosion. If the Anodes have corroded significantly, renew immediately. If the Anodes/unit shows signs of corrosion shortly after commissioning then it is important that the vessel electrical system is checked for earth leaks, or other electrical faults that are possibly accelerating the corrosion process.

There are 6 anodes fitted to the under water area, 2 on the Propeller shaft and 4 mounted directly on to the base plate

Recommended anode inspection plan.

First six (6) months	- One	(1) month intervals.
Six (6) months to one (1) year	- Three	(3) month intervals.
One (1) year plus	- Six	(6) month intervals.

WARNING

- **Anodes are fitted to prevent the corrosion of the Thruster assembly, failure to change the Anodes can cause serious damage to your Thruster.**
- **Aluminium mounting plate should be checked regularly!**
- **The Thruster should not be used as an earth point.**
- **It is always advisable that a cathodic specialist performs a complete check of the vessels protection system.**

4.3 Manual Raise & Lower of Thruster

If the Thruster cannot be raise or lowered using Electrical power, it is possible to raise or lower the unit mechanically.

WARNING When lowering manually remove or isolate power to prevent injury.

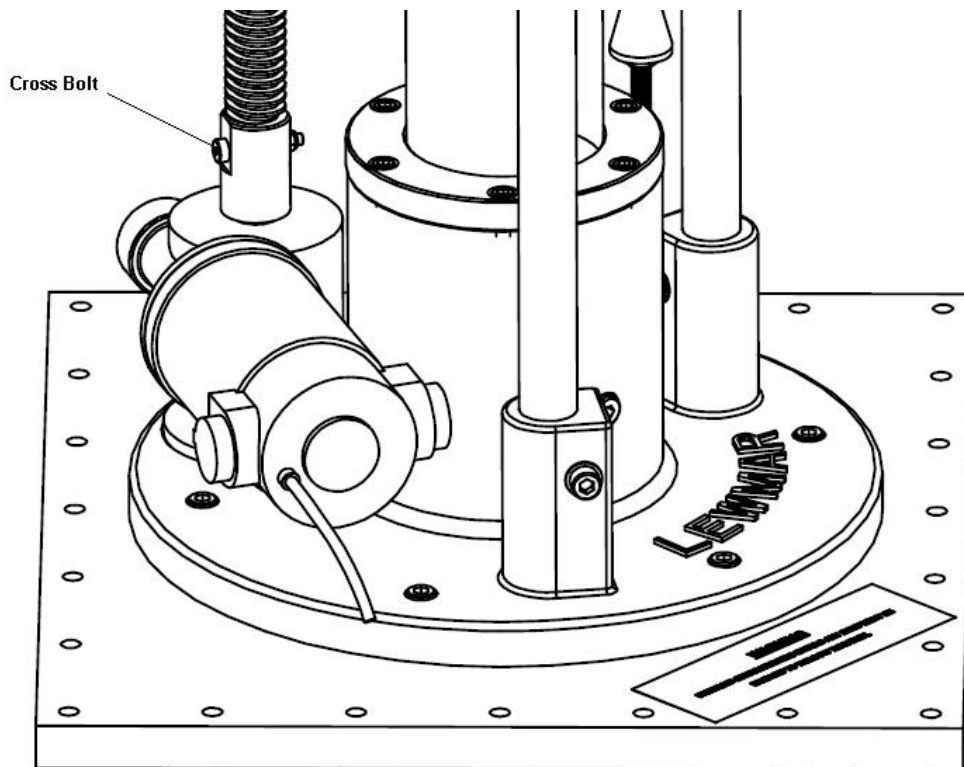

- 1) Remove 6mm Cross Bolt from the drive assembly of the raise/lower motor using a 8mm spanner and 3mm hex key.
Note: - When re-fitting, do not over tighten.
- 2) Place a suitable 17mm spanner or socket drive onto the top of the leadscrew. Clockwise to raise, Anti-clockwise to lower.
- 3) Turn the leadscrew to raise or lower, taking care not to damage the limit switches at the top and bottom of the stroke.
- 4) The Thruster is lowered under its own weight when the leadscrew is turned; it might be necessary to apply additional force to the top of the thruster to overcome stiction.

250 VRTT

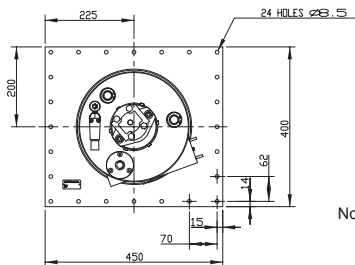
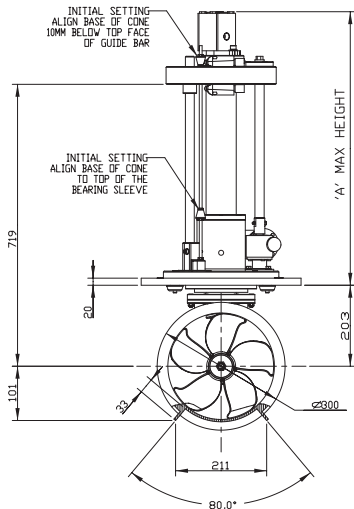
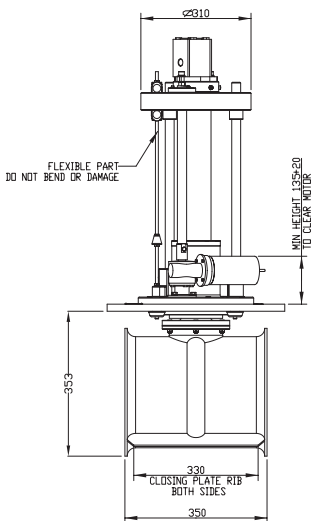

MODEL NO.	DIM 'A'	STROKE
59127002	721	300
59127004	711	300
59127100	911	300
59127110	941	300

Note: Version Shown is Hydraulic, Dim 'A'
Accounts for Both Electric & Hydraulic

LEWMAR

300 VRTT

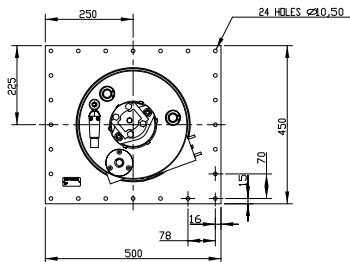
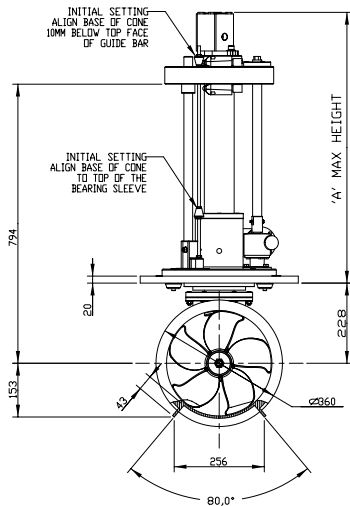
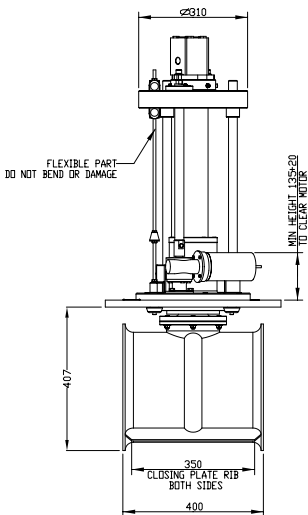

MODEL NO.	DIM 'A'	STROKE
59137001	765	350
59137002	765	350
59137003	751	350
59137004	751	350

LEWMAR

GB LEWMAR WARRANTY

Lewmar warrants its products in normal usage to be free of defects in materials and workmanship for a period of three years from date of purchase by the original purchaser, subject to the conditions, limitations and exceptions listed below. Any part, which proves to be defective in normal usage during that three-year period, will be repaired or at Lewmar's option, replaced by Lewmar.

A CONDITIONS AND LIMITATIONS

- i Lewmar's liability shall be limited to repair or replacement of the goods or parts defective in materials or workmanship.
- ii Determination of the suitability of the material for the use contemplated by the buyer is the sole responsibility of the buyer and Lewmar shall have no responsibility in connection with such suitability.
- iii Lewmar shall not be liable in any way for:
 - a Failures, loss or damage due to use of products in applications for which they are not intended.
 - b Failures, loss or damage due to corrosion, ultra violet degradation, wear and tear or improper installation.
 - c Failures, loss or damage due to incorrect maintenance.
 - d Failures, loss or damage due to conditions that exceed the product's performance specifications.
- iv Product subject to warranty claim must be returned to Lewmar for examination unless otherwise agreed by Lewmar in writing.
- v Lewmar shall not be responsible for shipping charges nor installation labour associated with any warranty claim.
- vi Service by anyone other than authorised Lewmar representatives shall void this warranty unless it accords with Lewmar guidelines and standards of workmanship.
- Vii Lewmar's products are intended for use only for marine purposes. Buyers intending to use them for any other purpose should seek advice from Lewmar, and Lewmar shall be under no liability arising from use, which Lewmar has not approved.

B EXCEPTIONS

Warranty is limited to a period of one year from the date of purchase in the case of the following:

- Electric motors and electrical equipment
- Electronic controls
- Hydraulic pumps, valves and actuators
- Weather seals
- Products used in "Grand Prix" racing applications

C LIABILITY

- i Lewmar's liability under this warranty shall be to the exclusion of all other warranties or liabilities (to the extent permitted by law). In particular (but without limitation):
 - a Lewmar shall not be liable for:
 - Any indirect or consequential loss including (without limitation) any loss of anticipated profits, damage to reputation or goodwill, loss of expected future business, damages, costs or expenses payable to any third party or any other indirect losses.
 - Any damage to yachts or equipment.
 - Death or personal injury (unless caused by Lewmar's negligence).
 - b Lewmar grants no warranties regarding the fitness for purpose, use, nature or satisfactory quality of the goods.
- ii Where the laws of the country do not permit a warranty to be excluded, then such warranty, if permitted by that country's law, shall be limited to a period of one year.

D SEVERANCE CLAUSE

If any clause of these warranties is held by any competent authority to be invalid or unenforceable in whole or in part of the validity of the other clauses of this warranty and the remainder of the clause in question shall not be affected.

E This warranty gives you specific legal rights, and you may also have other legal rights, which vary, from country to country.

Where the products are sold in the UK under a consumer transaction, the buyer's statutory rights are not affected

Lewmar Limited reserves the right to alter design and specification without prior notice.

TERMS AND CONDITIONS OF SALE

All sales are subject to Lewmar's General Terms and Conditions of Sale, which can be obtained from Lewmar Limited Head Office in Havant. The foregoing warranty and the following General Conditions of Sale form part only of, but also supplement, Lewmar's General Terms and Conditions of Sale. In the event of any conflict between the foregoing warranty and the following General Conditions of Sale on the one hand and Lewmar's full General Terms and Conditions of Sale on the other, Lewmar's full General Terms and Conditions of Sale shall prevail.

Prices

All prices are subject to change without prior notice due to the fluctuating costs of materials and wages. Prices are ex-warehouse and are those ruling at the date of despatch and exclude VAT, which will be charged as appropriate.

Quotations

Any quotation is open for acceptance for a period of 30 days from the date of quotation. Quotations can only be regarded as firm when they are put in writing. (Verbal estimates are made purely for indicative purposes.)

Return of goods

RETURNED GOODS WILL NOT BE ACCEPTED NOR CREDIT ISSUED UNLESS THE RETURN IS AUTHORISED BY LEWMAR IN WRITING.

An authorisation will be issued on approval of return.

All carriage charges on returned goods must be prepaid.

All returned goods accepted and subsequently returned to our stock will be subject to a 15% restocking charge.

Items returned in a damaged condition will not be credited at full value.

Custom fabricated items or parts will not be accepted for return.

Catalogues

Sales literature and product manuals are available from Lewmar on request. These items can also be ordered from our Web site.

Availability

Goods can be obtained from your local boat builder or chandler. We will be pleased to inform you of your nearest supplier.

D GARANTIE VON LEWMAR LIMITED

Lewmar garantiert für einen Zeitraum von drei Jahren ab Kaufdatum – den normalen Gebrauch der Produkte vorausgesetzt – daß seine Produkte keine Herstellungs- oder Materialfehler aufweisen. Diese Gewährleistung erfolgt zu den Bedingungen und mit den Beschränkungen und Ausnahmen, die nachstehend aufgeführt sind. Teile, die sich bei normalem Gebrauch während der dreijährigen Garantiezeit als fehlerhaft erweisen, werden von Lewmar repariert oder aufgrund Lewmar's Entscheidung ausgetauscht.

A BEDINGUNGEN UND EINSCHRÄNKUNGEN

- i Die Haftung von Lewmar ist auf die Reparatur oder den Austausch der Teile beschränkt, die Material- oder Herstellungsfehler aufweisen.
 - ii Die Feststellung, ob das Material für die vom Käufer bezweckte Verwendungsart geeignet ist, fällt unter die alleinige Verantwortung des Käufers. Lewmar übernimmt keine Haftung im Zusammenhang mit einer solchen Eignungsfeststellung.
 - iii Lewmar kann nicht haftbar gemacht werden für:
 - a Versagen, Verlust oder Schäden aufgrund der Nutzung der Produkte in Anwendungen, für die sie nicht bestimmt sind.
 - b Versagen, Verlust oder Schäden durch Korrosion, UV-Zersetzung, normalen Verschleiß oder falsche Installation.
 - c Versagen, Verlust oder Schäden durch falsche Wartung.
 - d Versagen, Verlust oder Schäden durch Überbeanspruchung der Produkte.
 - iv Produkte, für die Garantieansprüche geltend gemacht werden, müssen an Lewmar zwecks Prüfung zurückgesandt werden, es sei denn, daß Lewmar schriftlich eine andere Vereinbarung bestätigt hat.
 - v Lewmar übernimmt keine Frachtkosten oder Kosten für Installationsarbeiten im Zusammenhang mit einem Garantieanspruch.
 - vi Diese Garantie verfällt, wenn andere Personen als zugelassene Lewmar-Vertreter Servicearbeiten in Bezug auf die Produkte durchführen, es sei denn, daß diese Arbeiten den Richtlinien und Herstellungsstandards von Lewmar entsprechen.
 - vii Lewmar Produkte sind ausschließlich für den Einsatz im Wassersport- bereich konzipiert. Käufer, die diese Produkte für jeglichen anderen Zweck benutzen wollen, sollten das Einverständnis von Lewmar einholen; Lewmar unterliegt dabei keiner Haftung durch den Gebrauch, den Lewmar nicht ausdrücklich gebilligt hat.
- ### B AUSNAHMEN
- Die Garantie ist in folgenden Fällen für die Zeitdauer eines Jahres, beginnend mit dem Datum des Verkaufes befristet:
- Elektrische Motoren und elektrische Ausrüstung
 - Elektronische Steuerungen
 - Hydraulische Pumpen, Ventile und Drehzahlregler
 - Wetterdichtungen
 - Produkte im „Grand Prix“-Einsatz

C HAFTUNG

- i Die Haftung seitens Lewmar schließt alle anderen Garantien und Verantwortlichkeiten (in dem Maße, wie das Gesetz dies zuläßt) aus. Insbesondere (jedoch nicht limitativ):
 - a haftet Lewmar nicht für
 - eventuelle indirekte Schäden oder Folgeschäden einschließlich (jedoch ohne Begrenzung) entgangener erwarteter Gewinne, des Verlusts von erwartetem zukünftigem Geschäfte, Schädigung von Ruf oder Goodwill sowie einschließlich Schäden, Kosten oder Aufwendungen, die an Dritte zahlbar sind sowie einschließlich anderer indirekter Verluste;
 - Schäden an Yachten oder Ausrüstung;
 - Tod oder Personenschäden (ausgenommen verursacht durch Fahrlässigkeit von Lewmar).
 - b Lewmar gewährt keine Garantie bezüglich der Eignung der Produkte hinsichtlich

der vom Käufer bezweckten Nutzung, des Gebrauchs, der Art, der Marktgängigkeit oder der befriedigenden Qualität der Produkte.

- ii Wenn die relevanten Gesetze des betreffenden Landes den Ausschluß von Garantien nicht erlauben, wird die Garantie, falls die Gesetze dies zulassen, auf ein (1) Jahr beschränkt.

D ABTRENNBARKEIT EINZELNER BESTIMMUNGEN

Falls eine oder mehrere dieser Garantiebestimmungen von einer zuständigen Behörde ganz oder teilweise für nicht gültig oder nicht einklagbar erachtet werden, mindert dies nicht die Gültigkeit der übrigen Bestimmungen dieser Garantie und des Rests der betreffenden Bestimmung.

E Aufgrund dieser Garantie haben Sie bestimmte gesetzmäßige Rechte; darüber hinaus stehen Ihnen gegebenenfalls von Land zu Land unterschiedliche sonstige gesetzmäßige Rechte zu.

Werden die Produkte im UK unter Verbraucherbedingungen verkauft, sind die gesetzmässigen Rechte des Käufers nicht betroffen.

Lewmar Limited behält sich das Recht vor, das Design, die Konstruktion und die Spezifikationen von Produkten ohne vorherige Ankündigung zu ändern.

ALLGEMEINE VERKAUFSBEDINGUNGEN

Alle Verkäufe unterliegen den Allgemeinen Verkaufsbedingungen von Lewmar in ihrer vollständigen Fassung, die auf Anfrage bei der Hauptniederlassung von Lewmar Marine in Havant, Großbritannien, erhältlich ist. Die obige Garantie und die folgenden allgemeinen Verkaufsbedingungen sind Bestandteil und Ergänzung dieser vollständigen Allgemeinen Verkaufsbedingungen von Lewmar. Im Falle von Widersprüchen zwischen der obigen Garantie und den folgenden allgemeinen Verkaufsbedingungen einerseits und den vollständigen Allgemeinen Verkaufsbedingungen von Lewmar andererseits sind die vollständigen Allgemeinen Verkaufsbedingungen maßgeblich.

PREISE

Alle Preise unterliegen eventuellen Änderungen ohne vorherige Ankündigung aufgrund von fluktuierenden Material- und Lohnkosten. Die Preise verstehen sich ab Lager und ohne Mehrwertsteuer (die in Rechnung gestellt wird, falls anwendbar) und sind die Preise, wie sie am Versanddatum gelten.

ANGEBOTE

Alle Angebote sind für den Zeitraum von 30 Tagen ab dem Angebotsdatum gültig. Angebote gelten nur als verbindlich, wenn sie schriftlich unterbreitet wurden. (Mündliche Aussagen dienen nur zu Indikationszwecken.)

RÜCKSENDUNG VON WAREN

ZURÜCKGESANDTE WAREN WERDEN NUR DANN ANGENOMMEN UND GUTGESCHRIEBEN, WENN LEWMAR DER RÜCKSENDUNG SCHRIFTLICH ZUGESTIMMT HAT.

Eine Genehmigung wird bei Zustimmung zur Rücksendung ausgestellt.

Alle Frachtkosten für Rücksendungen müssen vom Rücksender im voraus bezahlt werden.

Alle zurückgesandten Waren, die angenommen und später wieder an unser Lager zurückgesandt wurden, unterliegen einer Wiedereinlagerungsgebühr in Höhe von 15% des Warenwertes.

Artikel, die in beschädigtem Zustand zurückgesandt wurden, werden nicht zum vollen Wert gutgeschrieben.

Sonderanfertigungen sind von der Rücknahme ausdrücklich ausgeschlossen.

KATALOGE

Katalog- und Prospektmaterial sowie Produkthandbücher sind auf Anfrage bei Lewmar erhältlich. Diese Artikel können auch auf unserer Internetseite angefordert werden.

BEZUGSMÖGLICHKEITEN

Unsere Produkte können Sie bei Ihrer örtlichen Werft oder dem ortsansässigen Lewmar-Händler beziehen. Wir teilen Ihnen gerne die Anschrift des Lieferanten in Ihrer Nähe mit.



F GARANTIE LIMITÉE & CONDITIONS GÉNÉRALES DE VENTE

LEWMAR garantit ses produits, dans des conditions normales d'utilisation, contre toutes pièces défectueuses ou défauts de fabrication pendant trois ans à partir de la date d'achat par l'acheteur d'origine, sous réserve des conditions, restrictions et exceptions listées ci-après. Toute pièce qui s'avère défectueuse à la suite d'une utilisation normale au cours de cette période de trois ans sera réparée ou remplacée par LEWMAR, qui sera seul juge du bien-fondé de sa décision de réparer ou remplacer ladite pièce.

A Conditions et restrictions

- La responsabilité de LEWMAR sera limitée à la réparation ou au remplacement des marchandises ou pièces présentant des défauts de matériel ou de fabrication.
- Il incombe à l'acheteur seul de déterminer si le matériel est adapté à l'usage auquel il le destine et LEWMAR ne saurait être tenu responsable de toute décision en ce domaine.
- LEWMAR ne reconnaît aucune responsabilité pour:
 - Les pannes, pertes et détériorations consécutives à une utilisation inadéquate des produits.
 - Les pannes, pertes et détériorations causées par la corrosion, la dégradation par ultraviolets, l'usure normale ou une installation inadéquate.
 - Les pannes, pertes et détériorations dues à un entretien inadéquat.
 - Les pannes, pertes et détériorations dues à des conditions qui ne sont pas prévues par les spécifications du produit.
- Tout produit faisant l'objet d'une réclamation sous garantie devra être renvoyé à LEWMAR pour être examiné, sauf stipulation contraire par écrit de LEWMAR.
- LEWMAR n'est pas responsable des frais d'expédition ou de main d'œuvre associés à toute réclamation sous garantie.
- Tout entretien effectué par quiconque autre que les représentants agréés LEWMAR annulera cette garantie, sauf s'il est effectué en accord avec les directives et normes de fabrication de LEWMAR.
- Les produits LEWMAR sont destinés à un usage marin. Les acheteurs destinant les produits LEWMAR à un usage autre que celui-ci doivent préalablement prendre conseil auprès de LEWMAR, qui décline toute responsabilité vis-à-vis d'un type d'usage qui n'aurait pas été approuvé par LEWMAR.

B Exceptions

La garantie est limitée à une période d'un an à compter de la date d'achat pour les produits suivants:

- Moteurs électriques et équipement électrique
- Commandes électroniques
- Pompes hydrauliques, valves et dispositifs de commande
- Jointes étanches
- Produits utilisés dans les épreuves de type «Grands Prix»

C Responsabilité

- La responsabilité de LEWMAR dans le cadre de la présente garantie exclut toutes autres garanties ou responsabilités, sous réserve du respect des dispositions légales en vigueur et il est entendu que :
 - LEWMAR décline toute responsabilité pour:
 - tout dommage indirect ou tout préjudice financier consécutif incluant notamment, sans que la liste soit exhaustive, la perte de revenus anticipée, l'atteinte à la réputation ou à la clientèle, la perte de prospects, les dommages et intérêts, le coût et les dépenses qui doivent être payés à une tierce personne ou toute autre perte indirecte;
 - tout dommage causé aux yachts ou aux équipements;
 - le décès ou les dommages corporels des tiers (sauf en cas de faute établie de LEWMAR).
 - Il n'existe aucune garantie de vendabilité ni d'aptitude au but ou à l'usage ni de qualité satisfaisante de la marchandise.
 - Certains pays interdisent toute exclusion de garantie. Dans ce cas, la garantie,

si la loi l'autorise, sera limitée à une période d'un an.

D Séparation de clause

Si l'une des clauses de cette garantie était invalidée ou jugée inapplicable par une autorité compétente, en tout ou partie, la validité des autres clauses de cette garantie, ou la partie non contestée de la clause en question, ne serait pas affectée.

E Cette garantie vous donne des droits particuliers, mais vous pouvez également bénéficier d'autres droits qui varient selon les pays.

Lorsque les produits sont vendus au Royaume-Uni dans le cadre d'une opération de vente au public, les droits fondamentaux de l'acheteur restent sans changement.

LEWMAR Ltd se réserve le droit de modifier la conception et les spécifications de ses produits sans avertissement préalable.

CONDITIONS GENERALES DE VENTE

Toute vente est soumise aux Conditions Générales de Vente de LEWMAR qui peuvent être obtenues sur demande adressée à Lewmar Limited Head Office, Havant.

Les précédentes clauses de garantie ainsi que les conditions générales de ventes qui suivent y compris les suppléments font partie intégrante des Conditions Générales de Vente de LEWMAR et viennent les compléter. En cas de conflit entre d'une part les précédentes clauses de garantie et les conditions générales de vente qui suivent et d'autre part l'intégralité des Conditions Générales de Vente de LEWMAR, il est entendu que ce sont ces dernières qui prévaudront.

Prix

Tous les prix peuvent être modifiés sans avis préalable en fonction des variations des prix des matériaux et du coût de la main d'œuvre. Les prix sont ex-entrepôt et correspondent aux prix en cours à la date d'envoi; les prix ne comprennent pas la TVA qui sera appliquée au taux en vigueur.

Devis

Tout devis reste soumis à réserve d'acceptation pendant une période de 30 jours suivant la date portée sur le devis. Les devis ne sont considérés comme définitifs que lorsqu'ils sont donnés par écrit (les devis verbaux sont donnés uniquement à titre indicatif).

Renvoi de marchandises

LES MARCHANDISES RETOURNEES NE SERONT PAS ACCEPTEES ET AUCUN REMBOURSEMENT NE SERA ACCORDE SANS AUTORISATION ECRITE DE LEWMAR.

Une autorisation sera délivrée à l'acceptation du retour.

Tous les frais de retour des marchandises doivent être réglés d'avance.

Toutes les marchandises acceptées et renvoyées ultérieurement à nos magasins seront soumises à 15% de frais de remise en stock. Les articles retournés en mauvais état ne seront pas remboursés dans leur totalité.

Les articles ou pièces fabriqués sur mesure ne peuvent pas être retournés.

Catalogues

Des catalogues, prospectus et manuels d'utilisation des produits LEWMAR seront expédiés par LEWMAR sur demande. Les articles figurant dans les documents énumérés ci-dessus peuvent également être commandés à partir de notre site Web.

Disponibilité

Les marchandises sont en vente chez votre chantier ou shipchandler local. Nous serons heureux de vous indiquer l'adresse du fournisseur le plus proche de votre domicile.

E GARANTIA

Lewmar garantiza sus productos en uso normal como exentos de defectos en materiales y mano de obra por un período de tres años a partir de la fecha de la compra por el comprador original, con sujeción a las condiciones, limitaciones y excepciones indicadas a continuación. Cualquier pieza que se demuestre que es defectuosa en su uso normal durante el dicho período de tres años será reparada o, a elección de Lewmar, sustituida por Lewmar.

A CONDICIONES Y LIMITACIONES

- La responsabilidad de Lewmar se limitará a la reparación o sustitución de las mercancías o piezas defectuosas en sus materiales o fabricación.
- La determinación de la adecuación del material para el uso que le pretende dar el comprador es responsabilidad única del comprador y Lewmar no tendrá responsabilidad alguna respecto a tal adecuación.
- Lewmar no tendrá responsabilidad alguna por:
 - Averías, pérdidas o daños debidas al uso de productos en aplicaciones para las que no fueron diseñados.
 - Averías pérdidas o daños debidas a la corrosión, degradación por rayos ultravioleta, desgaste normal o instalación inadecuada.
 - Averías pérdidas o daños debidas a mantenimiento incorrecto.
 - Averías pérdidas o daños debidas a uso en condiciones que exceden las especificaciones de utilización del producto.
- El producto sujeto a reclamación de garantía ha de enviarse a Lewmar para su examen a no ser que se acuerde de otra manera por escrito por Lewmar.
- Lewmar no será responsable de los gastos de transporte ni del trabajo de instalación correspondiente a cualquier reclamación de garantía.
- El mantenimiento llevado a cabo por cualquiera que no sea un representante autorizado de Lewmar causará que la presente garantía quede anulada a no ser que sea hecho de acuerdo con las directrices y normas de mano de obra de Lewmar.
- Los productos Lewmar están destinados solamente para uso en aplicaciones marinas. Los compradores que pretendan utilizarlos en cualquier otra aplicación deben consultarlo a Lewmar, y Lewmar no tendrá ninguna responsabilidad surgida en una utilización no aprobada por Lewmar.

B EXCEPCIONES

La garantía se limita a un periodo de un año a partir de la fecha de la compra en los casos siguientes:

- Motores eléctricos y equipo eléctrico
- Controles electrónicos
- Bombas, válvulas y actuadores hidráulicos
- Juntas de estanqueidad
- Productos usados en aplicaciones de competición tipo "Grand Prix"

C RESPONSABILIDAD

- La responsabilidad de Lewmar bajo esta garantía excluye la aplicación de cualquier otra garantía o responsabilidad (dentro de los límites permitidos por la ley). Particularmente (pero no exclusivamente):
 - Lewmar no será responsable de:
 - Cualquier daño indirecto o consecuencia incluyendo (sin limitación) cualquier pérdida de beneficios previstos, daño a la reputación o crédito, pérdida de futuros negocios esperados, daños, costes o gastos pagaderos a terceras partes o cualquier otra pérdida.
 - Cualquier daño a yates o su equipo.
 - Muerte o lesiones a personas (excepto si son debidas a negligencia por parte de Lewmar).
 - Lewmar no otorga garantías en lo referente a la adecuación al propósito, uso, naturaleza, comerciabilidad o calidad satisfactoria de los productos
 - Cuando las leyes de un país no permitan la exclusión de una garantía, dicha garantía estará limitada a un año, si la ley de tal país lo permite.

D CLÁUSULA DE SEPARACIÓN

Si alguna cláusula de esta garantía es dada como invalida o no aplicable en todo o en parte por alguna autoridad competente, la validez de la demás cláusulas y del resto de la cláusula en cuestión no se vera afectada.

E Esta garantía le da a usted derechos legales específicos, y puede tener además otros derechos legales que varían de un país a otro.

Cuando los productos son vendidos en el Reino Unido (UK) en una transacción de consumo los derechos del estatuto del comprador no quedan afectados.

Lewmar Limited se reserva el derecho a cambiar el diseño y las especificaciones sin aviso previo.

*Esta garantía cubre todos los productos presentados en los catálogos de Lewmar a partir de 1992 comprados después del 1 de Julio de 1992.

CONDICIONES GENERALES DE VENTA

Todas las ventas están sujetas a las condiciones generales de venta de Lewmar, disponibles en la oficina principal de Lewmar Marine Ltd en Havant (UK). La garantía precedente y las siguientes condiciones generales de venta son solo una parte de las condiciones generales de venta de Lewmar.

Precios

Todos los precios quedan sujetos a cambio sin previo aviso debido a la fluctuación de los costes de los materiales y salarios. Los precios se entienden por los materiales en nuestro almacén y serán los vigentes en la fecha del despacho y no incluyen el IVA que se cargará según sea apropiado.

Presupuestos

Cualquier presupuesto queda sujeto a su aceptación antes de transcurridos 30 días a partir de la fecha del mismo. Los presupuestos únicamente pueden considerarse en firme si se presentan por escrito (las estimaciones verbales se hacen puramente con fines indicativos).

Devolución de mercancías

LAS MERCANCÍAS DEVUELTAS NO SERÁN ACEPTADAS NI ABONADAS A NO SER QUE LA DEVOLUCIÓN ESTÉ AUTORIZADA POR ESCRITO POR LEWMAR.

Si se aprueba una devolución se emitirá una autorización.

Todos los gastos de transporte de las mercancías devueltas tienen que ser a portes pagados.

Todas las mercancías cuya devolución sea aceptada y que, consiguientemente sean devueltas a nuestros stocks quedarán sujetas a un cargo del 15% por gastos reinsertión en stock. Los artículos que se devuelvan deteriorados no serán abonados por la totalidad de su valor.

Los artículos o piezas fabricados por encargo o según especificaciones del cliente no serán aceptados para devolución.

Catálogos

Pueden obtenerse folletos de los productos dirigiéndose a Lewmar.

Disponibilidad

Nuestros productos se pueden obtener a través de astilleros y revendedores locales. Tendremos mucho gusto en informarle de su proveedor Lewmar más cercano.



S LEWMARS BEGRÄNSADE GARANTI

Lewmar garanterar att företagets produkter i normalt bruk är fria från defekter med avseende på material och utförande under en period av tre år från och med datum för inköp av den ursprungliga köparen med förbehåll för de villkor, begränsningar och undantag enligt nedanstående förteckning. Någon del som visar sig vara defekt i normalt bruk under denna treårsperiod kommer att repareras eller bytas ut av Lewmar.

A VILLKOR OCH BEGRÄNSNINGAR.

- i Lewmars ansvarsskyldighet skal begränsas till reparation eller utbyte av de artiklar eller de delar som är bristfälliga med avseende på material eller utförande.
- ii Att fastställa materialets lämplighet för den av köparen avsedda användningen är uteslutande köparens ansvar och Lewmar skall inte ha någon ansvarsskyldighet med anknytning till sådan lämplighet.
- iii Lewmar skall inte på något sätt vara ansvarig för:
 - a Bristfälligheter, förlust eller skada till följd av produkternas användning inom områden, som de inte är avsedda för.
 - b Bristfälligheter, förlust eller skada till följd av korrosion, ultraviolett nedbrytning, försitning eller felaktig installation.
 - c Bristfälligheter, förlust eller skada till följd av felaktigt underhåll.
 - d Bristfälligheter, förlust eller skada till följd av förhållanden som överskrider produktens prestandaspecifikation.
- iv Produkt som är föremål för anspråk enligt garantin måste returneras till Lewmar för undersökning såvida ej annat förfaringssätt skriftligen har medgivits av Lewmar.
- v Lewmar skall inte vara ansvarig för speditionsavgifter eller arbetskostnader för installation i samband med något anspråk enligt garantin.
- vi Underhållsarbete av någon annan person eller firma än av Lewmars auktoriserade representanter gör denna garanti ogiltig om detta arbete inte överensstämmer med Lewmars riktlinjer och normer för utförande.
- Vii Lewmars produkter är ämnade för endast marint bruk. Kunder vilka har för avsikt att använda produkterna till annat ändamål, måste söka råd från Lewmar och Lewmar kan aldrig belastas för användning som Lewmar inte har godkänt.

B UNDANTAG

Garantin begränsas till en period av ett år från inköpsdatum, för följande produkter:

- Elmotorer och elektrisk utrustning
- Elektroniska styrordningar
- Hydrauliska pumpar, ventiler och ställdon
- Väderbeständiga förslutningar
- Produkter som används i "Grand Prix-tävlingar"

C ANSVAR

Lewmar skall inte ansvara för:

- Någon indirekt förlust inklusive (utan begränsning) förväntade vinster, fördärvt rykte, eller goodwill, förlust av framtida affärer, skador kostnader eller utgifter till tredje part eller någon annan indirekt kostnad
- Någon skada på farkost eller utrustning
- Dödsfall eller personlig skada (förutsatt att ej åsamkats av Lewmars försumlighet).

Det finns inga garantier i syfte på säljbarhet av något slag, uttryckligen eller antydd, och inga garantier skall göras gällande enligt lag. Varaktigheten av sådana garantier som inte desto mindre görs gällande enligt lag till förmån för konsumenten skall begränsas till en period av ett år från och med nyinköp av användaren. I vissa länder medges inte begränsningar på hur länge en antydd garanti varar, varför ovanstående kanske inte gäller för Er.

D DELNINGS KLAUSUL

Lewmar skall inte vara ansvarig för följdskador på segelbåtar, utrustning eller annan egendom eller personer till följd av någon bristfällighet hos Lewmars utrustning. I vissa länder medges inte uteslutning eller begränsning av oförutsedda skador eller följdskador, varför ovanstående uteslutning kanske inte gäller för Er.

E Denna garanti ger Er bestämda laga rättigheter och Ni kan även ha andra laga rättigheter som kan avvika från land till land.

Lewmar Marine Ltd. förbehåller sig rätten att ändra konstruktion och specifikation utan förvarning.

ALLMÄNNA FÖRSÄLJNINGSVILLKOR

Våra detaljerade försäljningsvillkor kan anskaffas från vårt inregistrerade kontor i Havant, England. Vid en pågående reklamation under de gällande försäljningsvillkoren från respektive part. Om eventuell konflikt mellan dessa parter skulle uppstå, gäller Lewmars generella försäljningsvillkor.

Priser

Samtliga priser underkastas förändringar utan förvarning till följd av fluktuerande kostnader av material och arbetslöner. Priserna är fritt från lager och är de som gäller vid datum för avsändning och exklusive moms som kommer att debiteras enligt gällande förordningar.

Offerter

Alla offerter avges med förbehåll för godtagande under en period om 30 dagar från och med offertdatum. Offerter kan endast betraktas som fasta offerter när de avlämnas skriftligen (muntliga beräkningar avges endast i angivande syfte).

Returnering av varor

RETURNERADE VAROR KOMMER INTE ATT ACCEPTERAS ELLER KREDITERAS SÅVIDA INTE RETURNERINGEN SKRIFTLIGEN ÄR BEMYNDIGAD AV LEWMAR.

Ett bemyndigande kommer att utfärdas vid godkännande av returneringen.

Alla transportkostnader på returnerade varor måste vara förutbetalda.

Alla returvaror som accepterats och som därefter returneras till vårt lager blir föremål för en återlagringsavgift av 15% av varans pris. Artiklar som returneras i skadat skick kommer inte att krediteras till fullt värde.

Specialtillverkade artiklar eller delar kommer inte att accepteras för returnering.

Kataloger

Produktbroschyrer kan anskaffas från Lewmar på begäran. Dessa kan dessutom beställas över vår Hemsida på Internet.

Tillgänglighet

Varor kan anskaffas från Er lokala båtbyggare eller, återförsäljare av båtutrustning.

